

THEATRE ROYAL, NEWCASTLE-ON-TYNE.

THE proprietors of the Theatre Royal, Grey-street, Newcastle-on-Tyne, recently decided to make very extensive alterations to this theatre, which will make it not only one of the handsomest and most comfortable, but also one of the safest in the provinces. On the ground level from Grey-street there will be a new vestibule, the external elevation of which will be of Classic design, in harmony with the old front.

On the ground level from the vestibule is entered a large and richly-decorated circular entrance-hall, from which on each side is approached by wide staircases the dress-circle, and the stalls are reached by means of staircases on each side of the proscenium wall.

On the dress-circle level is a large and richly-decorated *foyer*, and saloons and lavatory accommodation are also provided for each tier, and everything for the convenience and comfort of the public has been provided.

The theatre will be lighted by electricity, with gas for use in case of emergency.

The seat-coverings, silk hangings, &c., will be carried out in a brown pink tone, and the colouring of the house will be in ivory and gold.

The whole of the auditorium and front of the house will be gutted and reconstructed in concrete and iron, and will, when finished, consist of four tiers, viz. :—Pit and stalls, dress-circle, upper-circle, and gallery, and will hold in all about 1,900 persons.

The interior of the theatre is of Renaissance design. The ventilation is being carried out on a simple system consisting of extracting the heated and vitiated air by means of exhausts, provision being made for allowing sufficient fresh air to pass into the building.

The whole of this construction will be fireproof, and the house will be protected with hydrants on each level and sprinklers in the roof and over the stage. Each tier is provided with two exits.

The plans have been drawn out by Mr. Walter Emden, of London, in conjunction with Mr. W. Lister Newcombe, of Newcastle, and the work will be carried out by Mr. W. C. Tyrie, of Newcastle, the constructional ironwork by Messrs. Lindsay, Neal & Co., of London, and the decorative plastering by the Veronese Co., of London.

W. E.



THEATRE ROYAL

NEWCASTLE ON TYNE

JOINT ARCHITECTS
WALTER EMDEN
W. LISTER NEWCOMBE

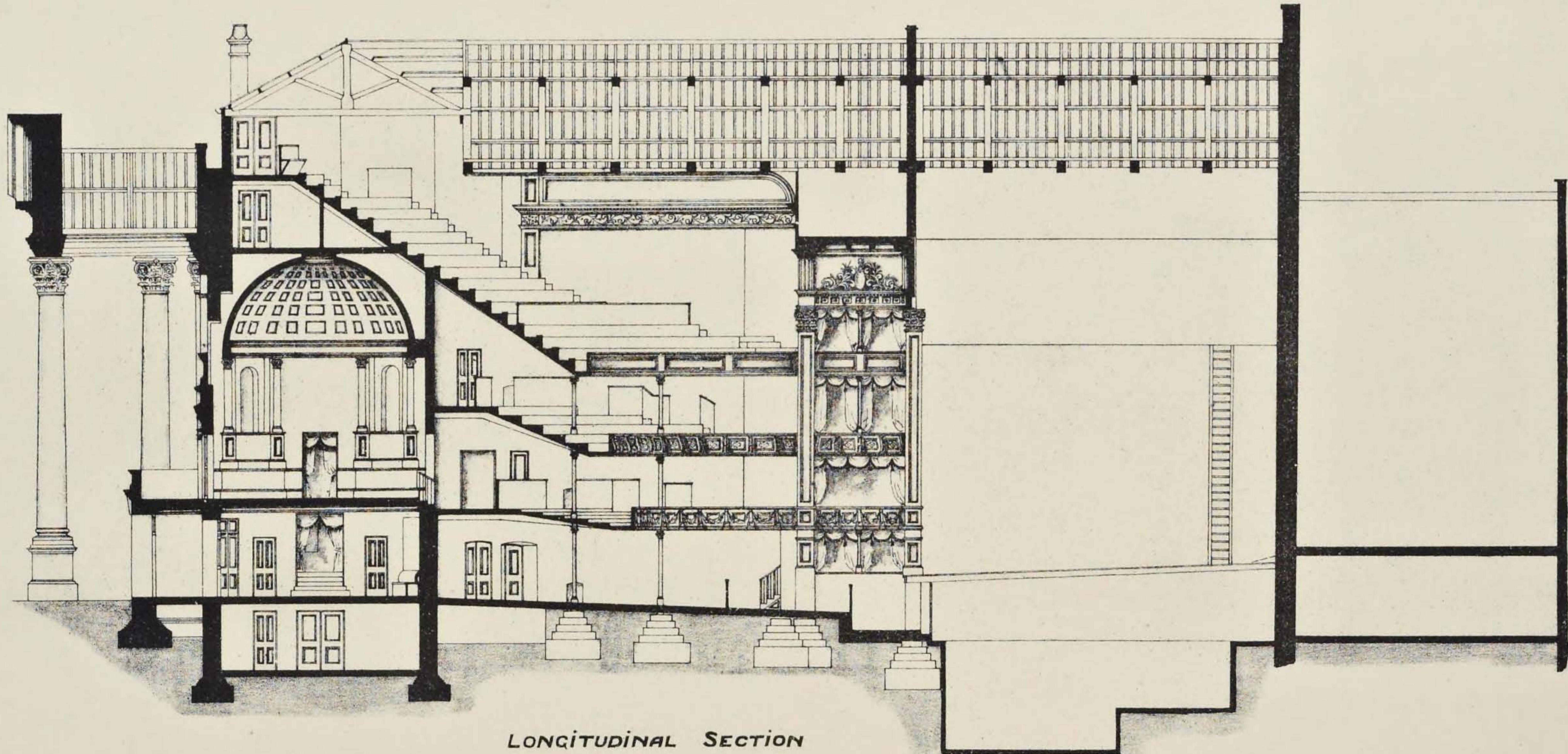

LONGITUDINAL SECTION

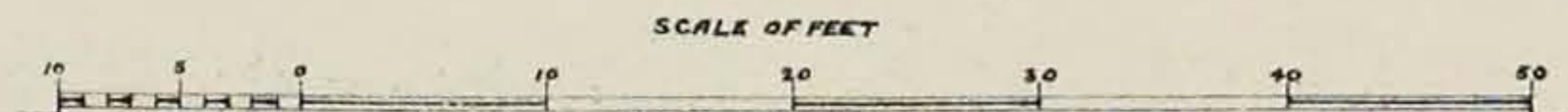

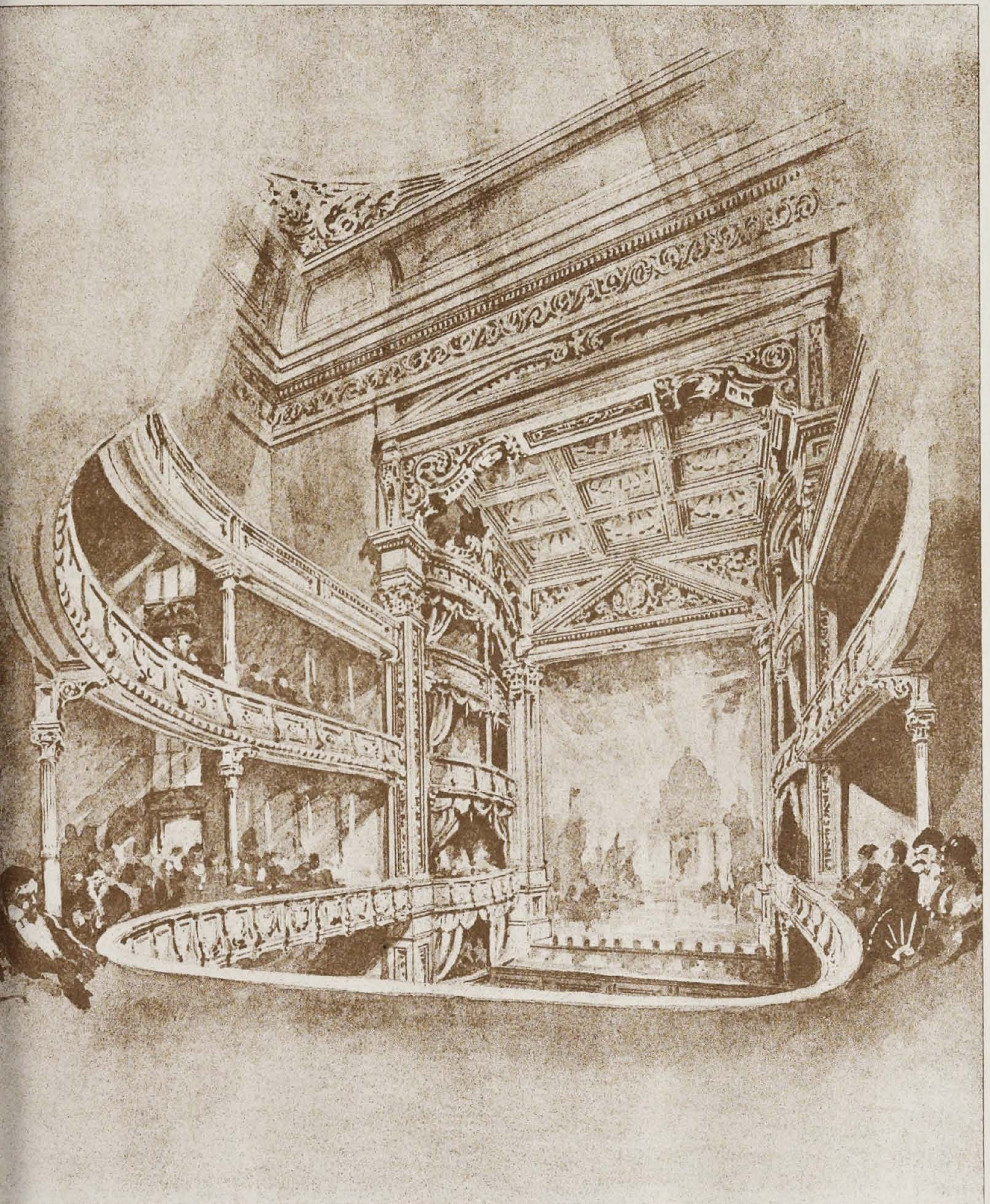

INK-PHOTO, SPRAGUE & CO. 4 & 5, EAST HARDING STREET, FETTER, LANE, E.C.

THEATRE ROYAL, NEWCASTLE: SKETCH OF INTERIOR.—MESSRS. W. EMDEN AND W. LISTER NEWCOMBE, JOINT ARCHITECTS.

JOINT ARCHITECTS
WALTER EMDEN
W. LISTER NEWCOMBE

WALTER EMDEN
W. LISTER NEWCOMBE

